

MFR™ / MFR XL™ RAIL

INSTALLATION INSTRUCTIONS

KEYMOD

WARNING! UNLOAD FIREARM BEFORE BEGINNING INSTALLATION

Failure to unload the firearm may lead to serious injury or death! // Place the weapon on safe. // Remove the magazine and cycle the bolt to remove any round from the upper receiver or chamber. // Visually inspect the chamber to make sure it is empty before proceeding with this installation procedure. // Be aware that you are solely responsible for your actions and for your own safety as well as the safety of those around you.

IMPORTANT NOTE: Remove muzzle device, front sight post/gas block (taper pins drive out from the ejection port side to the safety selector side), handguard cap and barrel nut. You do not need to remove the barrel.

TOOLS NEEDED FOR INSTALLATION:



- Allen wrench (supplied)
- DD BBL nut wrench (supplied)

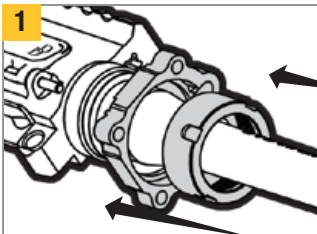

1. INSTALL BOLT-UP PLATE AND BARREL NUT (MFR Rail shown)

With the counter-bored side facing the muzzle, slide the MFR or MFR XL Rail Bolt-Up Plate over the barrel all the way to the upper receiver so that the alignment tab fits around the upper. Then slide the barrel nut over the barrel and thread onto the upper receiver hand-tight. Make sure that the gas tube hole in the MFR or MFR XL Rail Bolt-Up Plate aligns with the gas tube hole on the upper receiver.

NOTE: The Bolt-Up Plate may not fit some billet or non Mil-SPEC upper receivers.

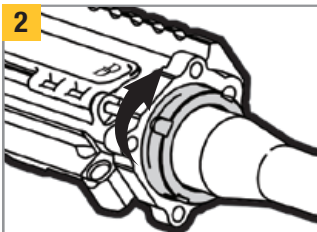

2. TIGHTEN THE BARREL NUT

Tighten the Bolt-Up System Barrel Nut and torque to 55 ft/lbs using the supplied Daniel Defense Bolt-Up System Barrel Nut Wrench.

NOTE: With the barrel nut and the Bolt-Up Plate installed properly, the Bolt-Up Plate will still move.

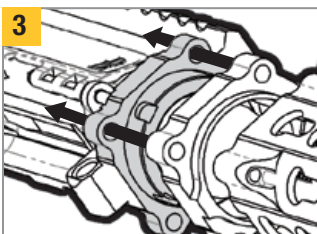

3. INSTALL THE BOLT-UP COLLAR

After the barrel nut has been installed and properly torqued, install the Bolt-Up Collar with the counter-bored side facing the upper receiver. Ensure that the indexing tab for the handguard is at the 6 o'clock position.

Install low-profile gas block and gas tube BEFORE proceeding.

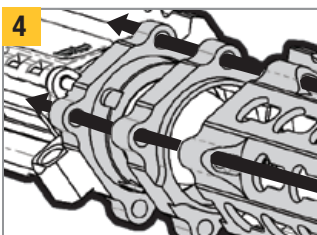

4. ALIGN AND ATTACH RAIL TO BOLT-UP SYSTEM

Place the MFR Rail over the barrel and mate it with the Bolt-Up Collar. Insert all 4 screws from the receiver toward the muzzle. Align top rail to handguard with top rail of upper.

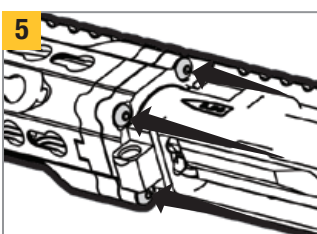

5. TIGHTEN THE RAIL

Tighten all four screws using the supplied allen wrench in an alternating pattern. Be careful not to overtighten. Once you feel resistance, an additional quarter to half a turn is enough. If you have an inch/pound torque wrench, the torque specification is 25-28 in/lbs. With the handguard fully installed, you can now reinstall your muzzle device.